

## G ELECTRICAL WIRING ROUTING

□ : Location of Connector Joining Wire Harness and Wire Harness

▽ : Location of Ground Points

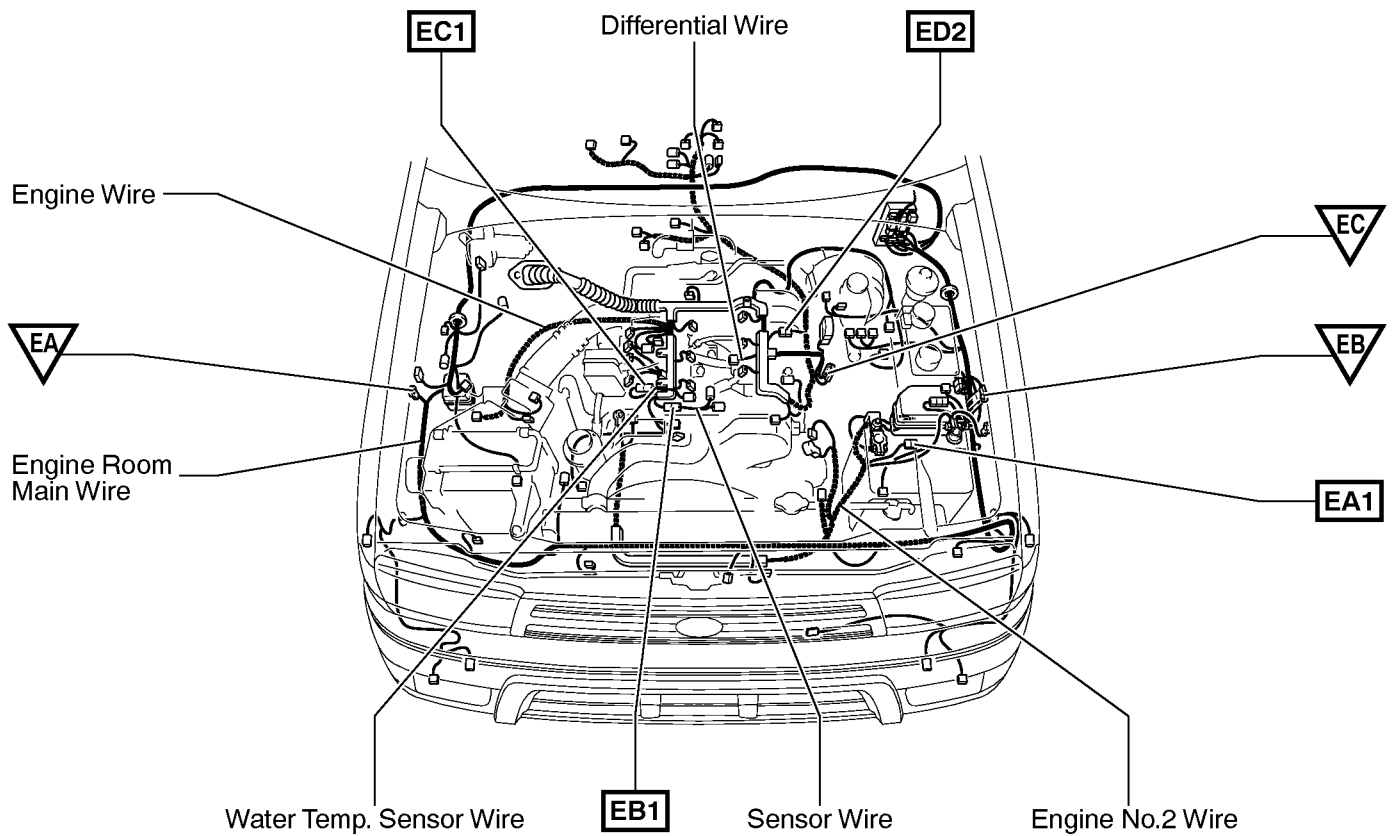

○ : Location of Splice Points

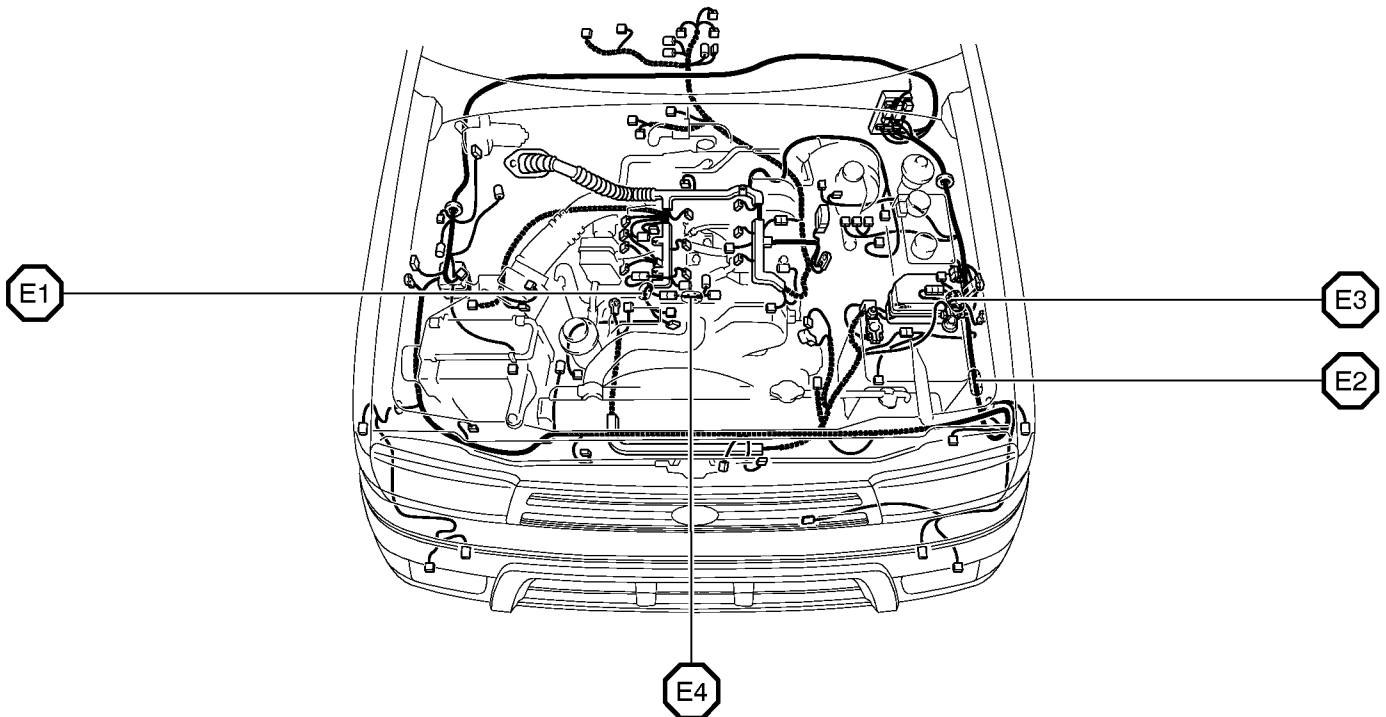

## Connector Joining Wire Harness and Wire Harness

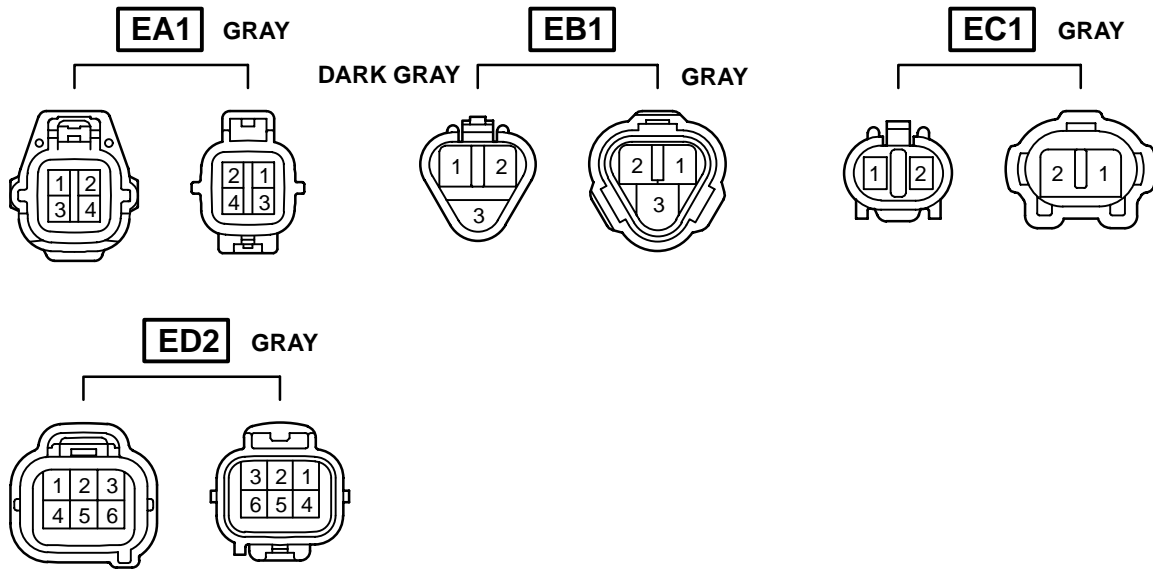

| Code | Joining Wire Harness and Wire Harness (Connector Location)                        |
|------|---|
| EA1  | Engine No.2 Wire and Engine Room Main Wire (Near the Engine Room R/B)             |
| EB1  | Sensor Wire and Engine Wire (Front Side of Cylinder Head Cover Right)             |
| EC1  | Engine Wire and Water Temp. Sensor Wire (Front Side of Cylinder Head Cover Right) |
| ED2  | Engine Wire and Differential Wire (Near the Front Differential)                   |

## G ELECTRICAL WIRING ROUTING

**□ : Location of Connector Joining Wire Harness and Wire Harness**

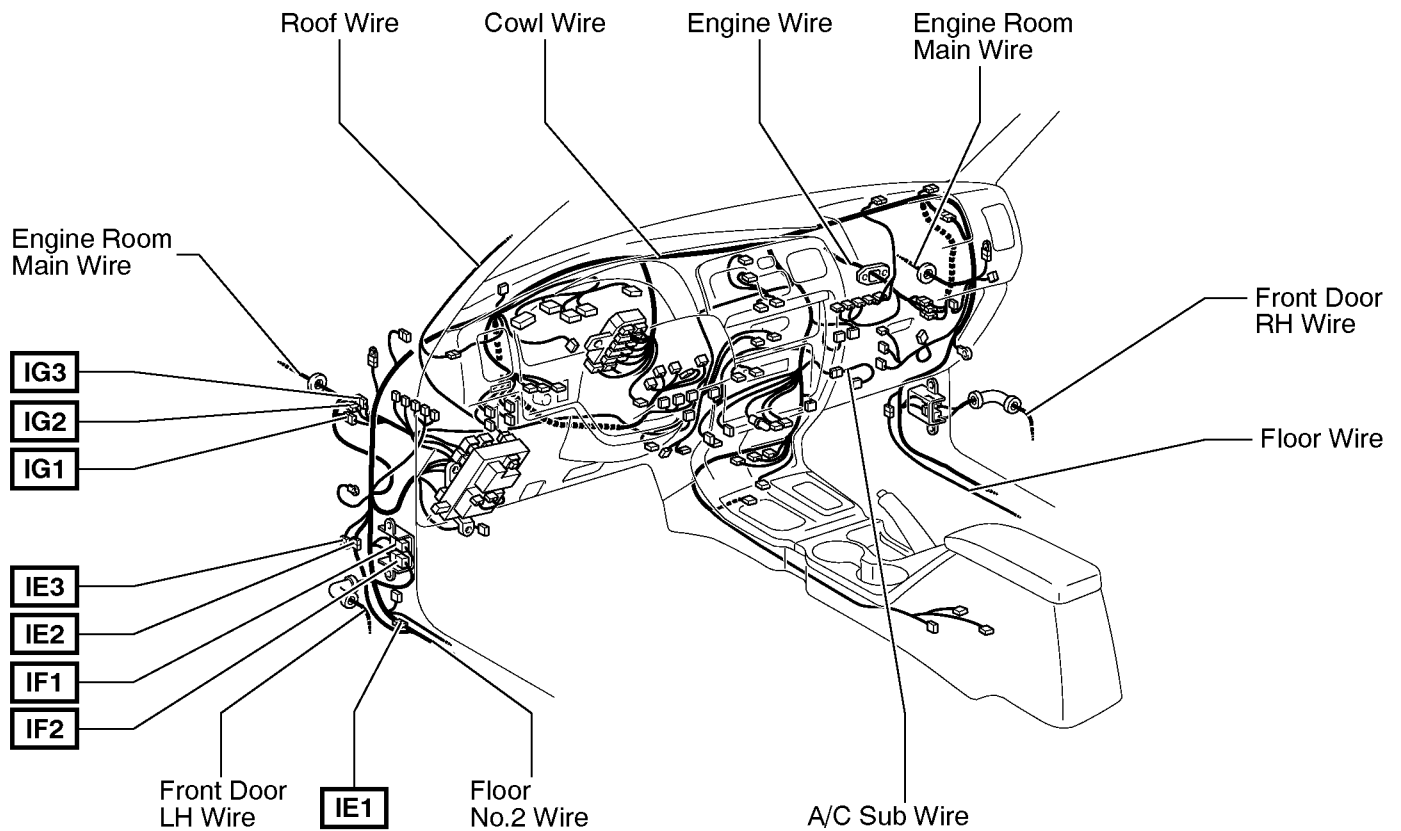

**▽ : Location of Ground Points**

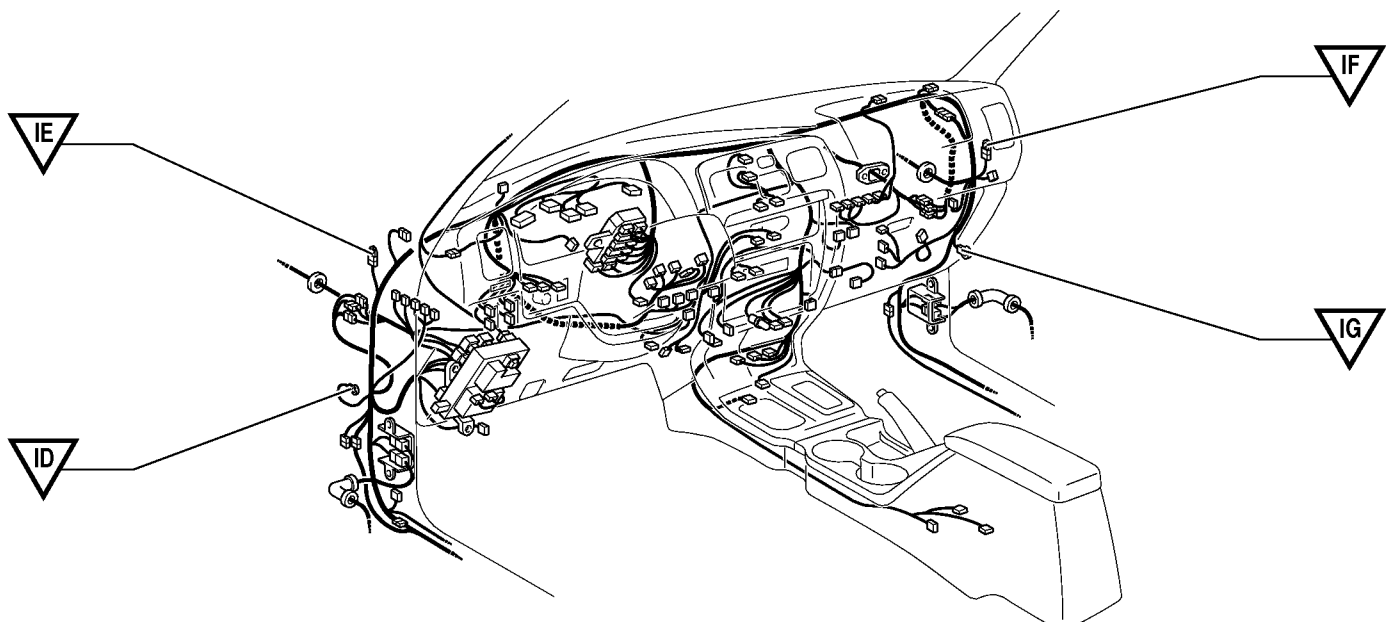

## Connector Joining Wire Harness and Wire Harness

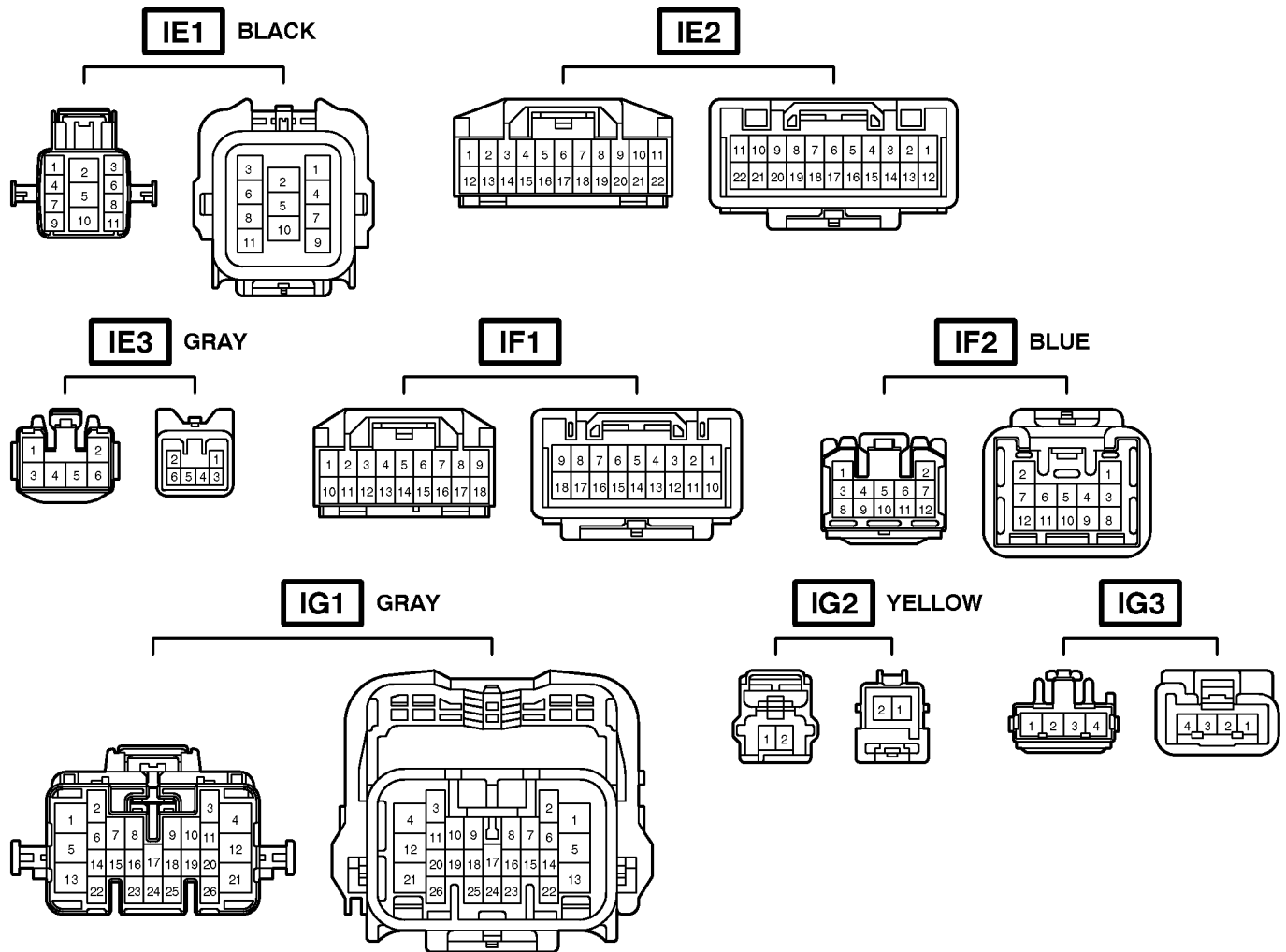

| Code | Joining Wire Harness and Wire Harness (Connector Location) |
|------|--|
| IE1  | Cowl Wire and Floor No.2 Wire (Left Kick Panel)            |
| IE2  |  |
| IE3  |  |
| IF1  | Front Door LH Wire and Cowl Wire (Left Kick Panel)         |
| IF2  |  |
| IG1  | Engine Room Main Wire and Cowl Wire (Left Kick Panel)      |
| IG2  |  |
| IG3  |  |

## G ELECTRICAL WIRING ROUTING

**□ : Location of Connector Joining Wire Harness and Wire Harness**

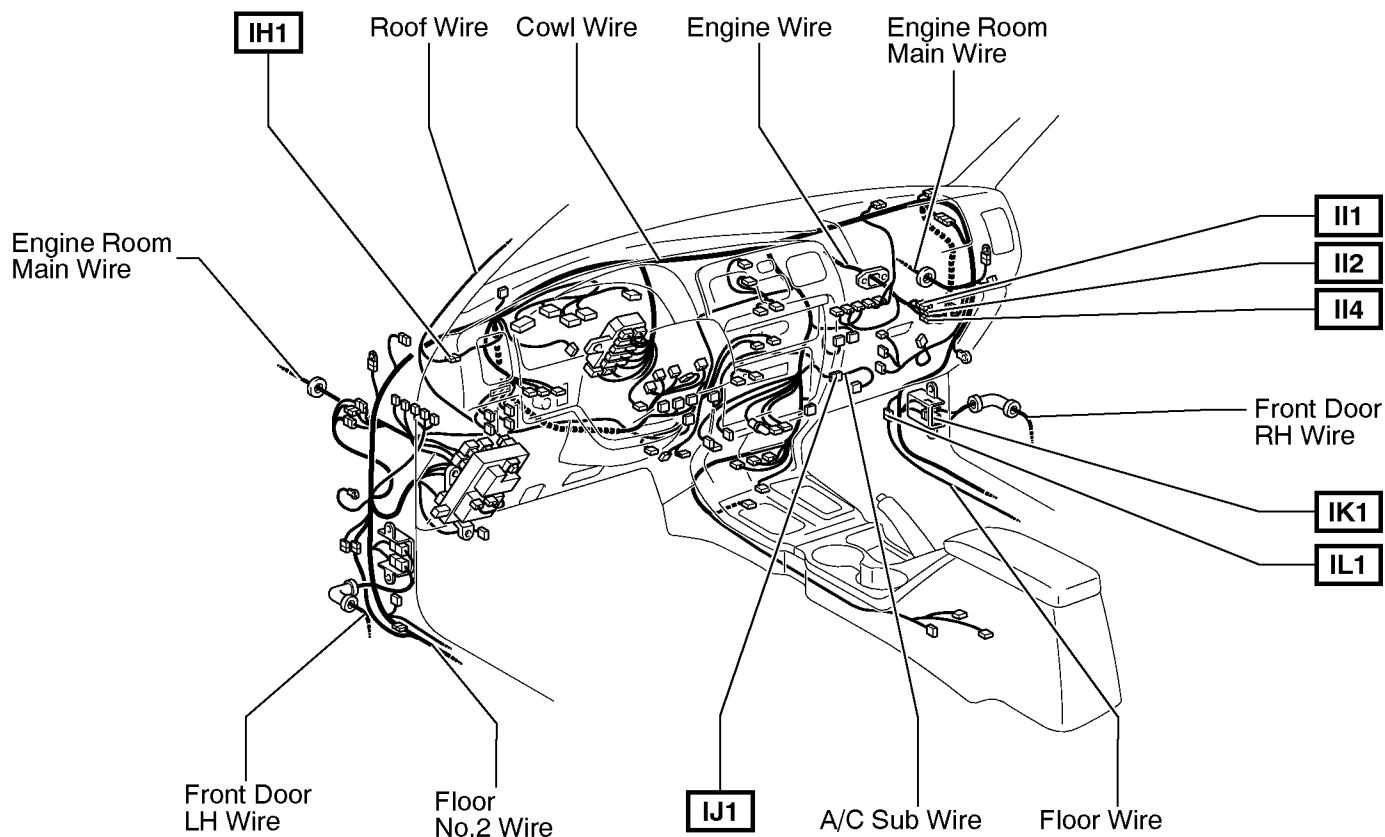

**○ : Location of Splice Points**

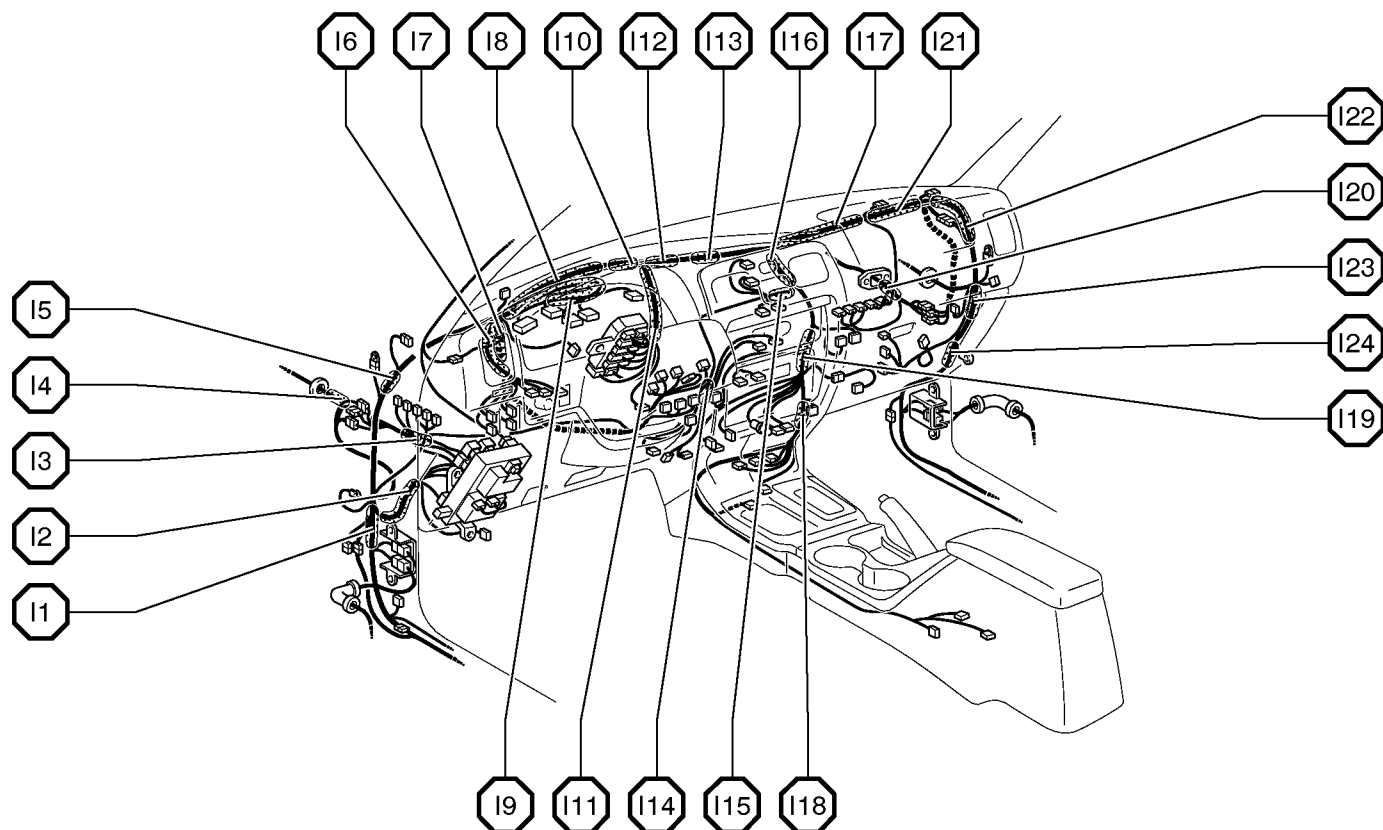

## Connector Joining Wire Harness and Wire Harness

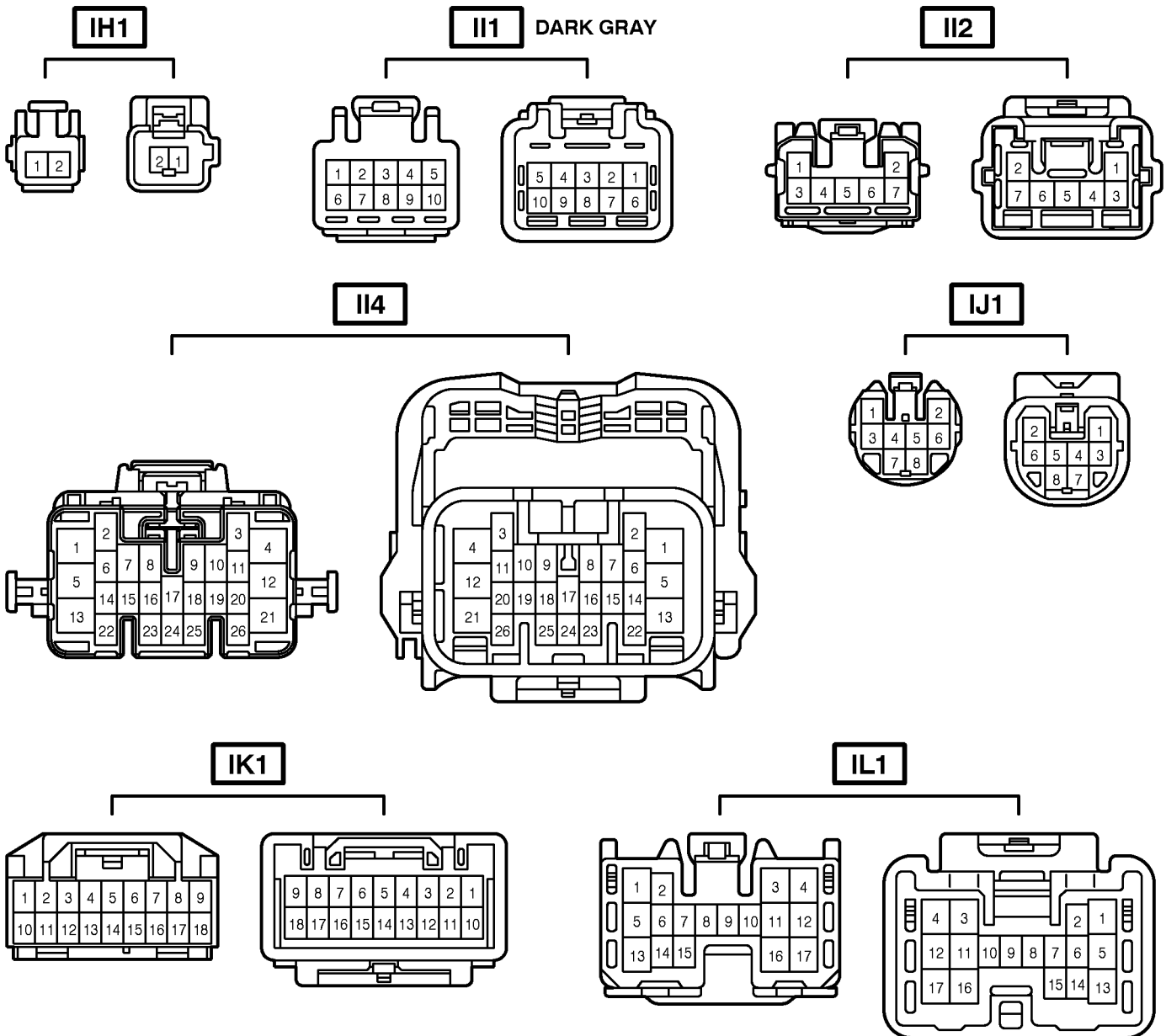

| Code | Joining Wire Harness and Wire Harness (Connector Location)    |
|------|---|
| IH1  | Roof Wire and Cowl Wire (Instrument Panel Reinforcement Left) |
| II1  | Engine Wire and Cowl Wire (On the Glove Box)                  |
| II2  |   |
| II4  |   |
| IJ1  | Cowl Wire and A/C Sub Wire (Near the A/C Unit)                |
| IK1  | Front Door RH Wire and Cowl Wire (Right Kick Panel)           |
| IL1  | Cowl Wire and Floor Wire (Right Kick Panel)                   |

## G ELECTRICAL WIRING ROUTING

□ : Location of Connector Joining Wire Harness and Wire Harness

▽ : Location of Ground Points

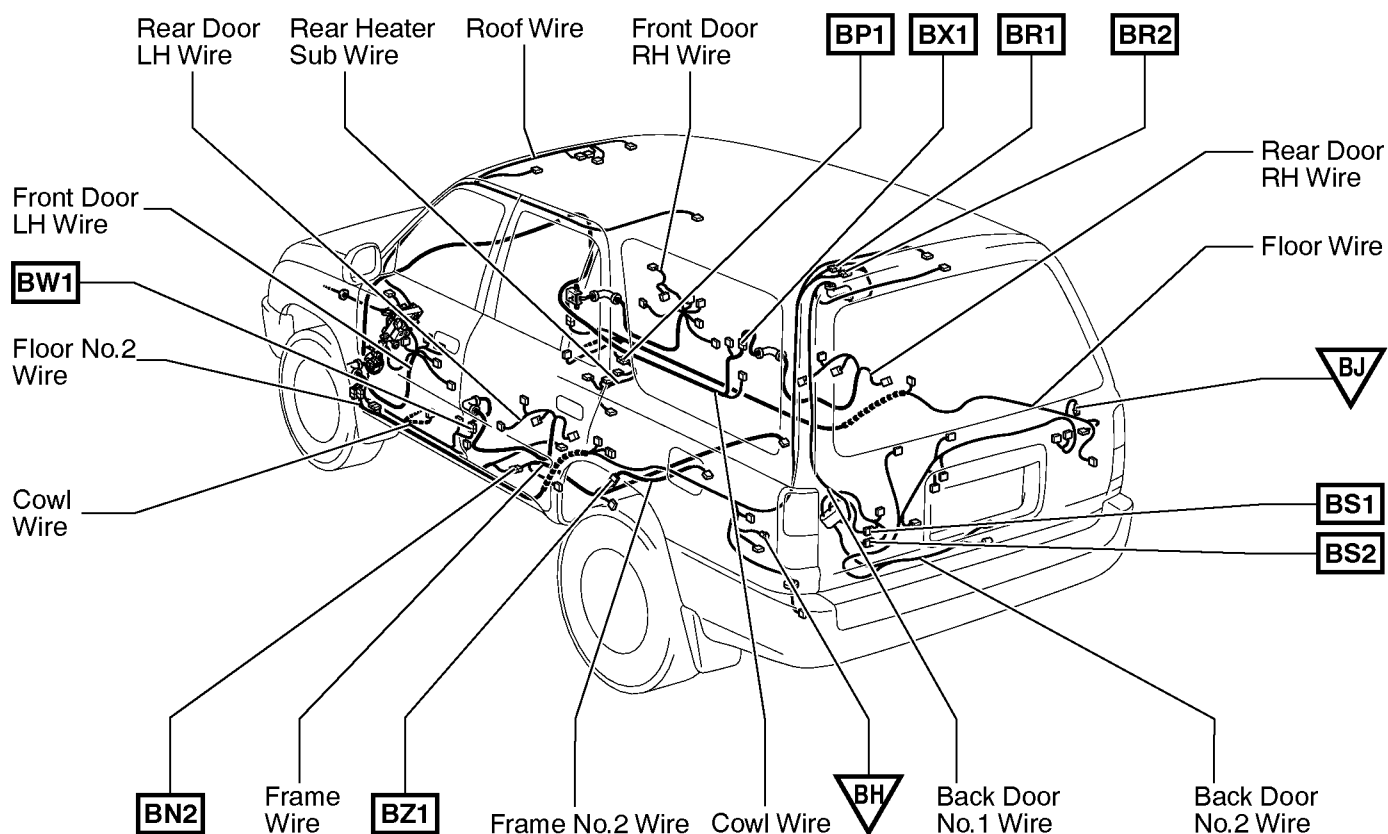

○ : Location of Splice Points

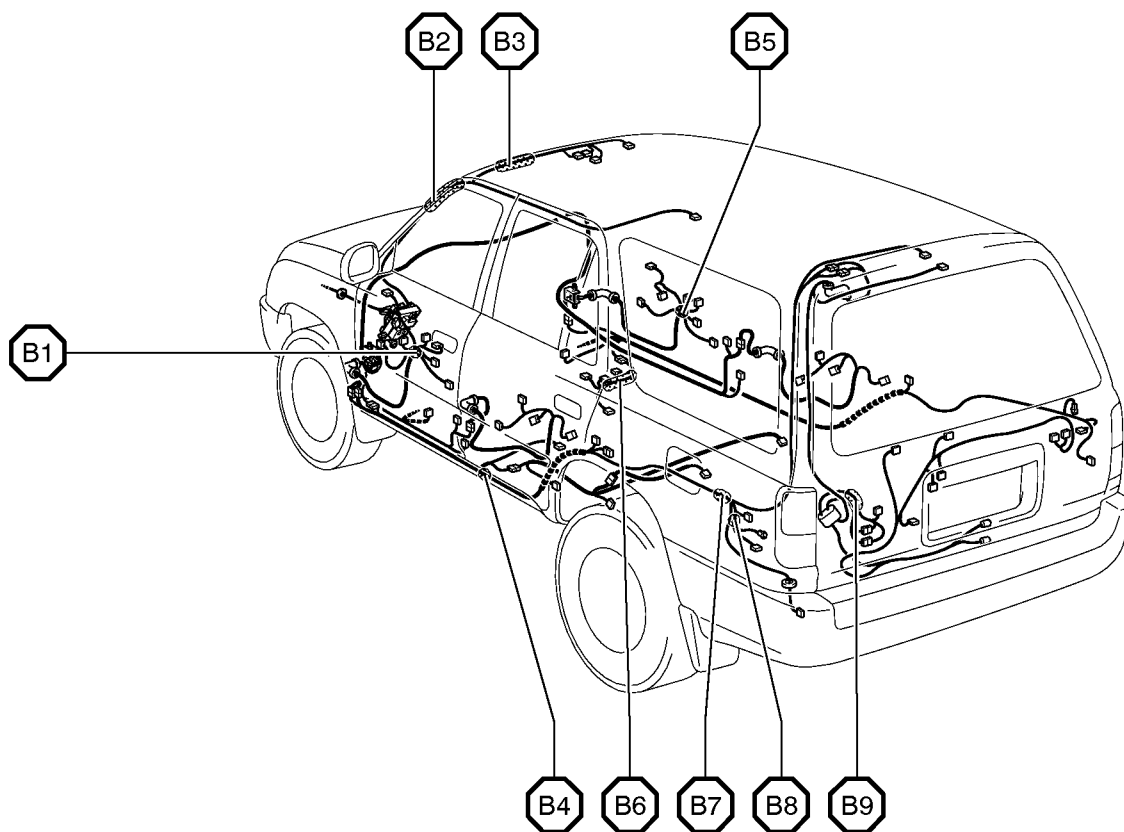

## Connector Joining Wire Harness and Wire Harness

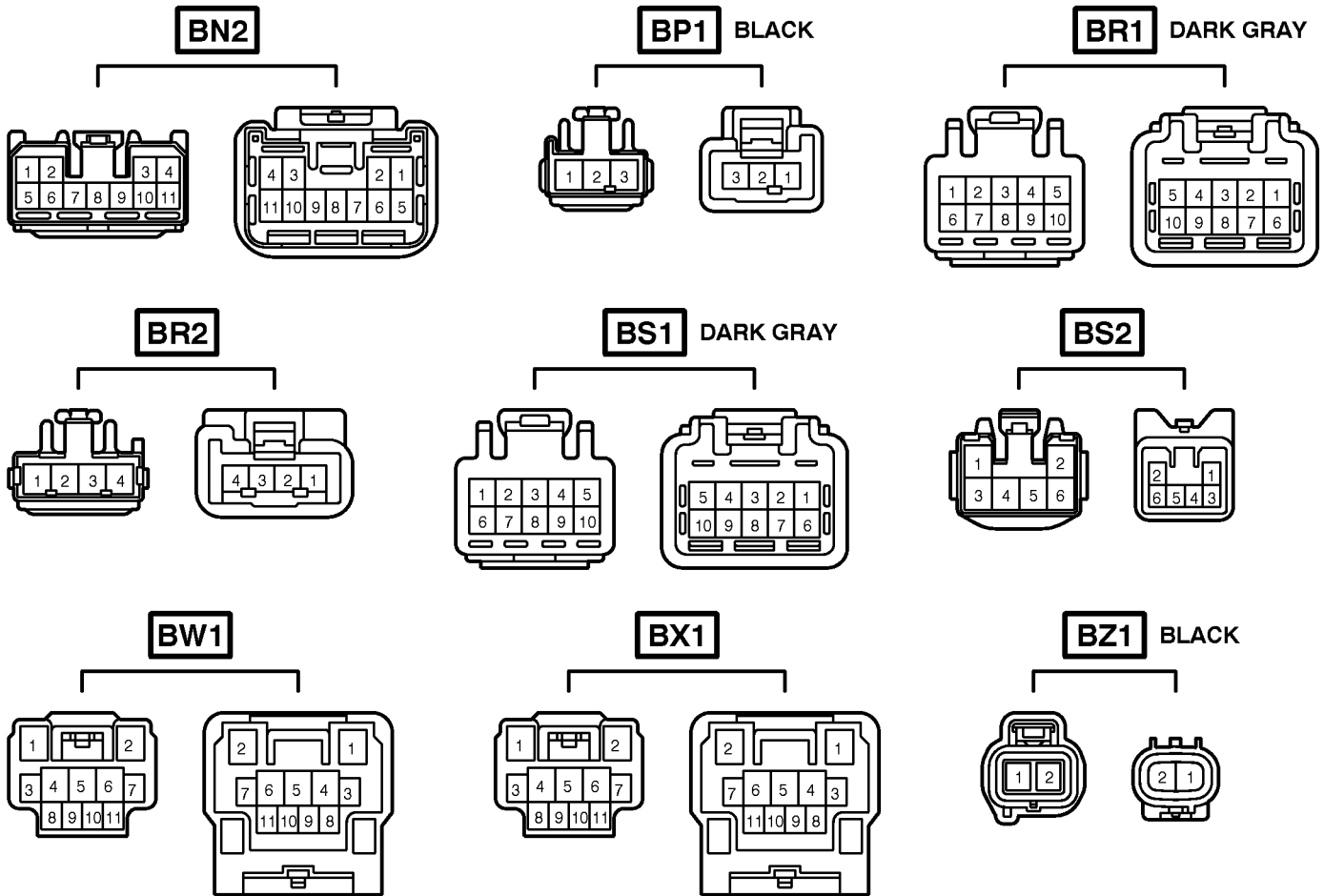

| Code | Joining Wire Harness and Wire Harness (Connector Location)                |
|------|---|
| BN2  | Frame Wire and Floor No.2 Wire (Under the Left Side of Rear Seat Cushion) |
| BP1  | Floor Wire and Rear Heater Sub Wire (Under the Front Passenger's Seat)    |
| BR1  | Back Door No.1 Wire and Floor No.2 Wire (Left Rear Side of Roof)          |
| BR2  | Back Door No.1 Wire and Back Door No.2 Wire (Back Door Left)              |
| BS1  | Back Door No.1 Wire and Back Door No.2 Wire (Back Door Left)              |
| BS2  | Back Door No.1 Wire and Back Door No.2 Wire (Back Door Left)              |
| BW1  | Rear Door LH Wire and Cowl Wire (Left Center Pillar)                      |
| BX1  | Rear Door RH Wire and Cowl Wire (Right Center Pillar)                     |
| BZ1  | Frame Wire and Frame No.2 Wire (Upper the Rear Axle Housing Left)         |



## G ELECTRICAL WIRING ROUTING

□ : Location of Connector Joining Wire Harness and Wire Harness

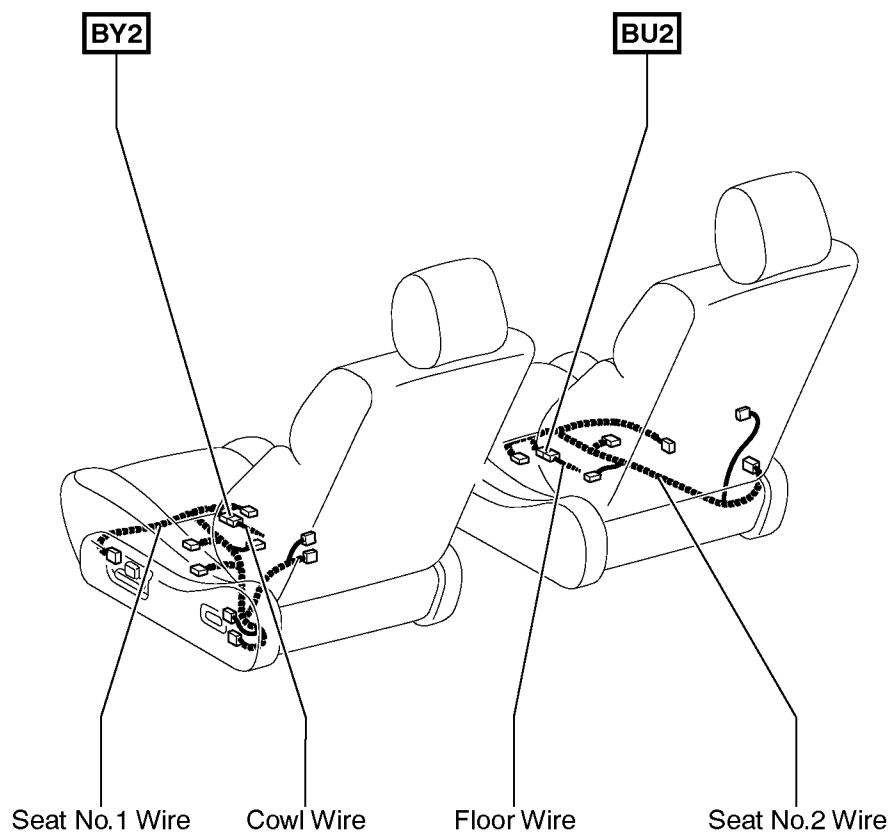

○ : Location of Splice Points

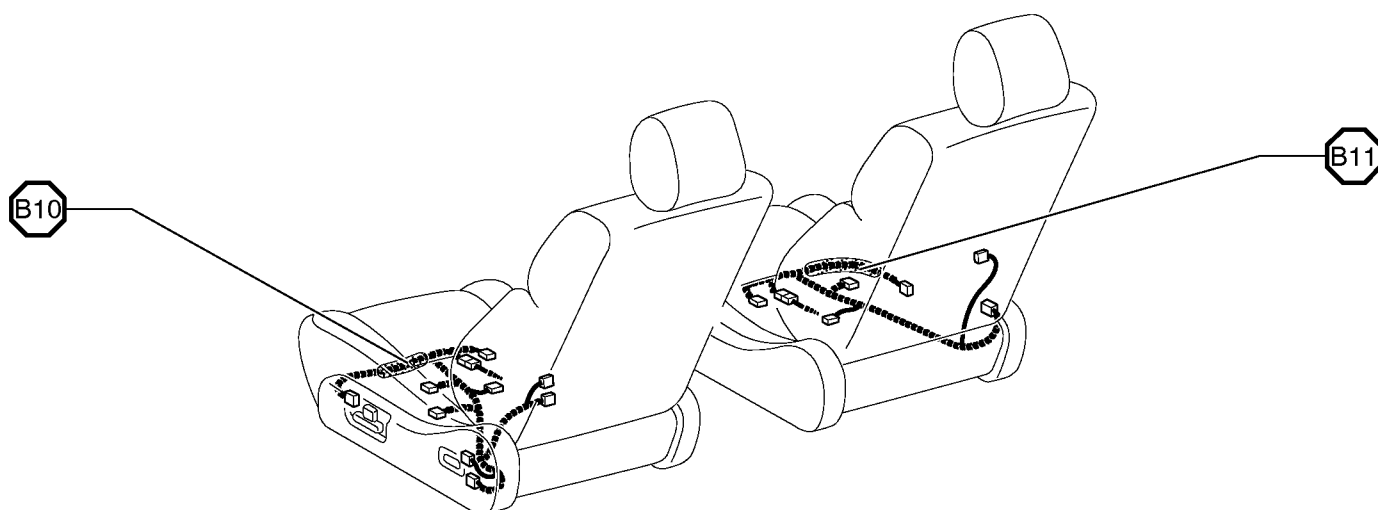

## Connector Joining Wire Harness and Wire Harness

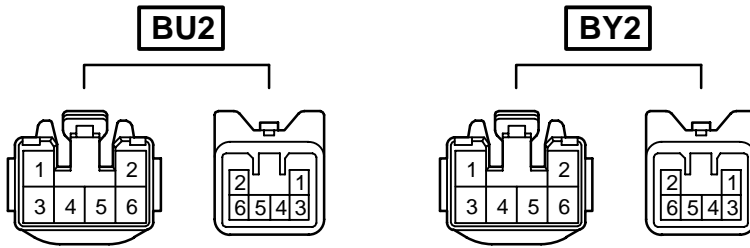

| Code | Joining Wire Harness and Wire Harness (Connector Location)       |
|------|--|
| BU2  | Floor Wire and Seat No.2 Wire (Under the Front Passenger's Seat) |
| BY2  | Cowl Wire and Seat No.1 Wire (Under the Driver's Seat)           |